

# MODEL 214

---

## DUAL-KNIFE TRIMMER/ DEFLASHER

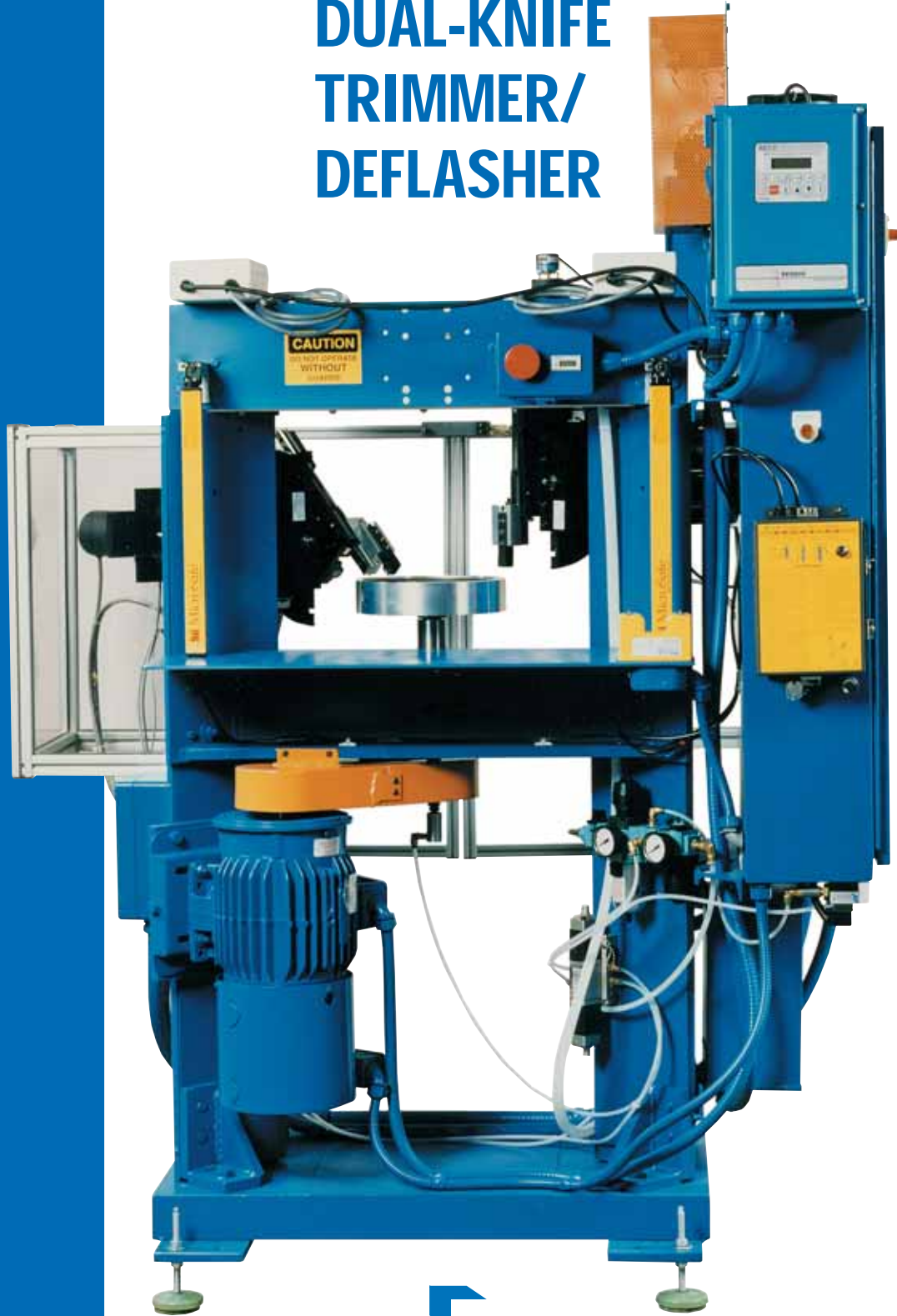

**Mitchell, Inc.**

---

1321 Leininger Ave, P.O. Box 413, Elkhart, IN 46515  
Fax: 574-295-3798 • Telephone: 574-295-3509  
[www.mitchell-inc.com](http://www.mitchell-inc.com)



## Model 214 Dual-knife Trimmer/Deflasher



Completely designed, engineered and built by Mitchell, this amazing machine offers a programmable interface terminal, on-board microcomputer control and other advanced componentry to provide your molding operation with automated productivity to increase your profits.

In addition, Model 214 requires virtually no set-up time. There's a low-to-no reject rate. You can depend on the repeatability of cut accuracies down to  $\pm 0.0005$ " on every cycle.

Cut angles from a  $-45^\circ$  to  $+90^\circ$  are possible in 2 axes, so most molded parts and virtually all materials can be accommodated on a Model 214.

Once the knives are positioned and the vacuum or mechanical hold-down (option) adjustment is set, the work cycle can begin. It really *is* that simple.

*NOTE: Model 215 is available with robotic loading. All other features are the same as on the 214.*

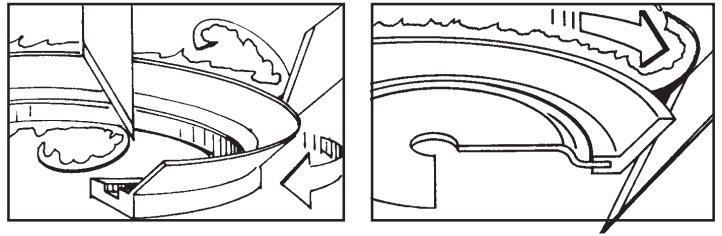

The following list of specifications and standard features is for reference only. Please contact Mitchell, Inc. for additional information.

### SPECIFICATIONS:

<b>SPINDLE SPEED:</b>	0-3,000 RPM
<b>ELECTRICAL SYSTEM:</b>	480 VAC 3-phase; 480 VAC transformers provided
<b>AIR SYSTEM:</b>	Requires 80 psi good clean compressed air; includes air cylinders, air filters, regulators
<b>SPINDLE:</b>	Precision milling spindle rated at 5,000 rpm, driven by timing belt
<b>DRIVE MOTOR:</b>	3 HP with solid state controlled AC vector drive
<b>MAX. PART SIZE:</b>	1" to 12" diameter, up to 2" thick; any elastomer, thermoplastic material
<b>MACHINE REPEATABILITY:</b>	$\pm 0.0005$ "
<b>ANGLES:</b>	$-45^\circ$ to $90^\circ$ on 2 knives
<b>AVAILABLE OPTIONS:</b>	Air-operated chuck, collet style chuck, vacuum style hold-down



### Mitchell, Inc.

1321 Leininger Ave, P.O. Box 413, Elkhart, IN 46515

Fax: 574-295-3798 • Telephone: 574-295-3509

[www.mitchell-inc.com](http://www.mitchell-inc.com)